

# MANIFOLD ABSOLUTE PRESSURE (MAP) SENSOR CONSTRUCTION/OPERATION [LF]

B3E014018213T02

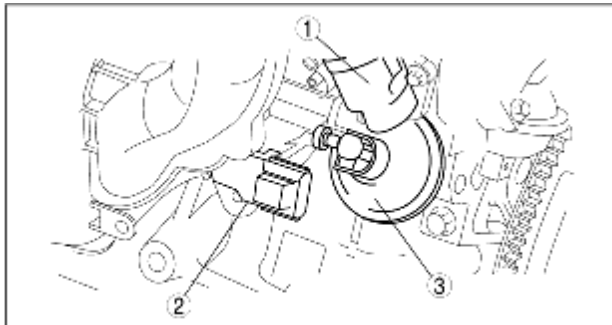

B3E0140T046

1	IAC solenoid valve
2	MAP sensor
3	Variable intake air shutter valve actuator

- When pressure is applied to the piezoelectric element in the sensor, an electric potential difference occurs. Output voltage increases as the intake air pressure increases.

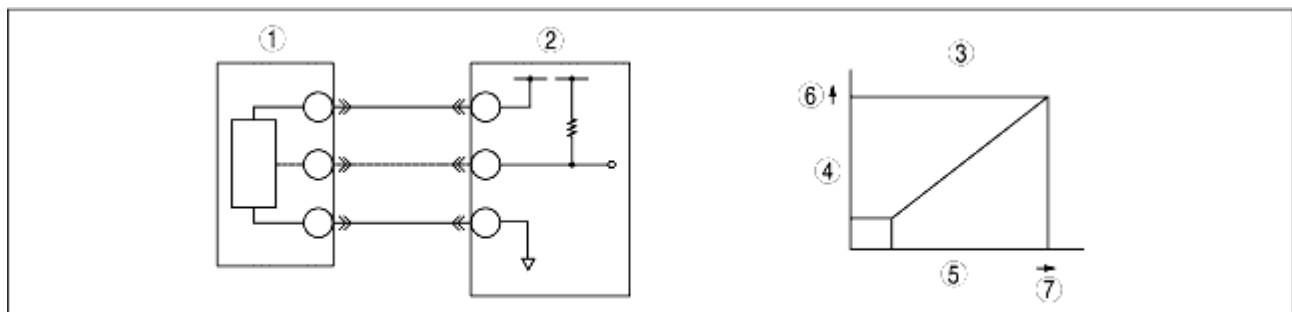

B3E0140T047

1	MAP sensor
2	PCM
3	MAP sensor characteristic
4	Output voltage
5	Intake air pressure
6	Large
7	High